

Site Location Map

1 : 1000

RED LINE HIGHLIGHTS THE EXTENT OF THE WORKS TO BE UNDERTAKEN

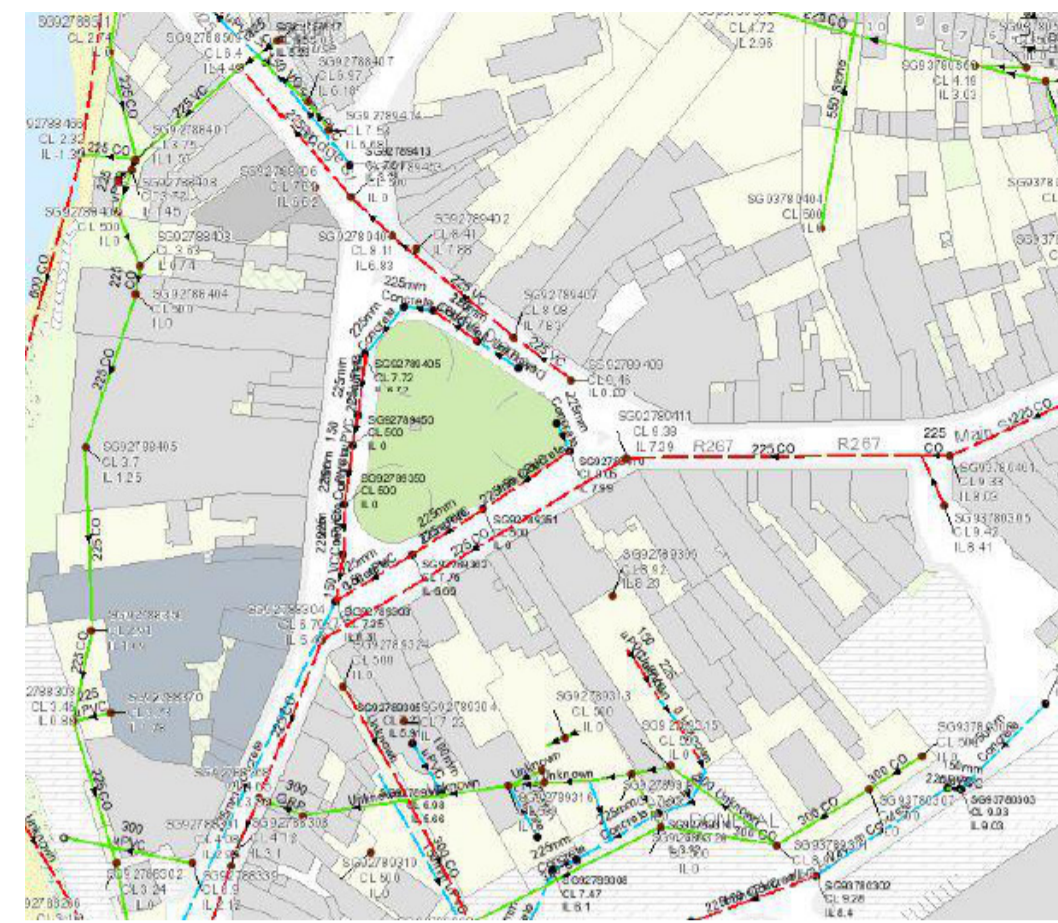

Foul & Stormwater Map - 01

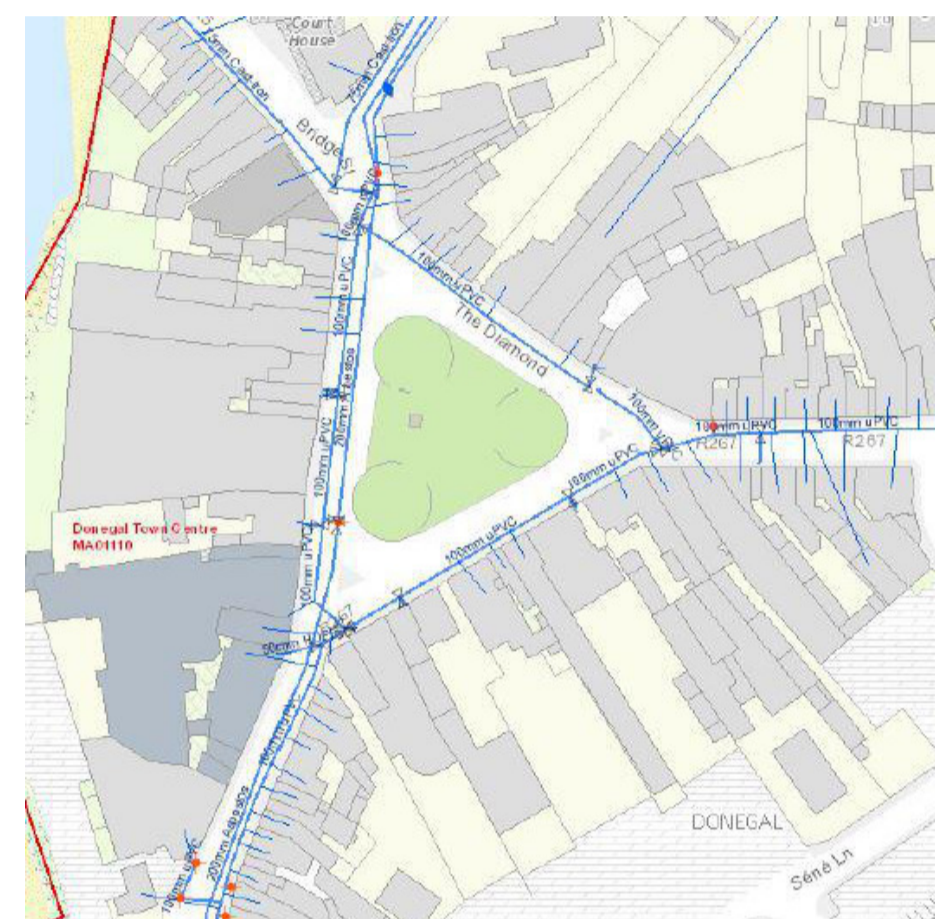

Mains Water Map - 02

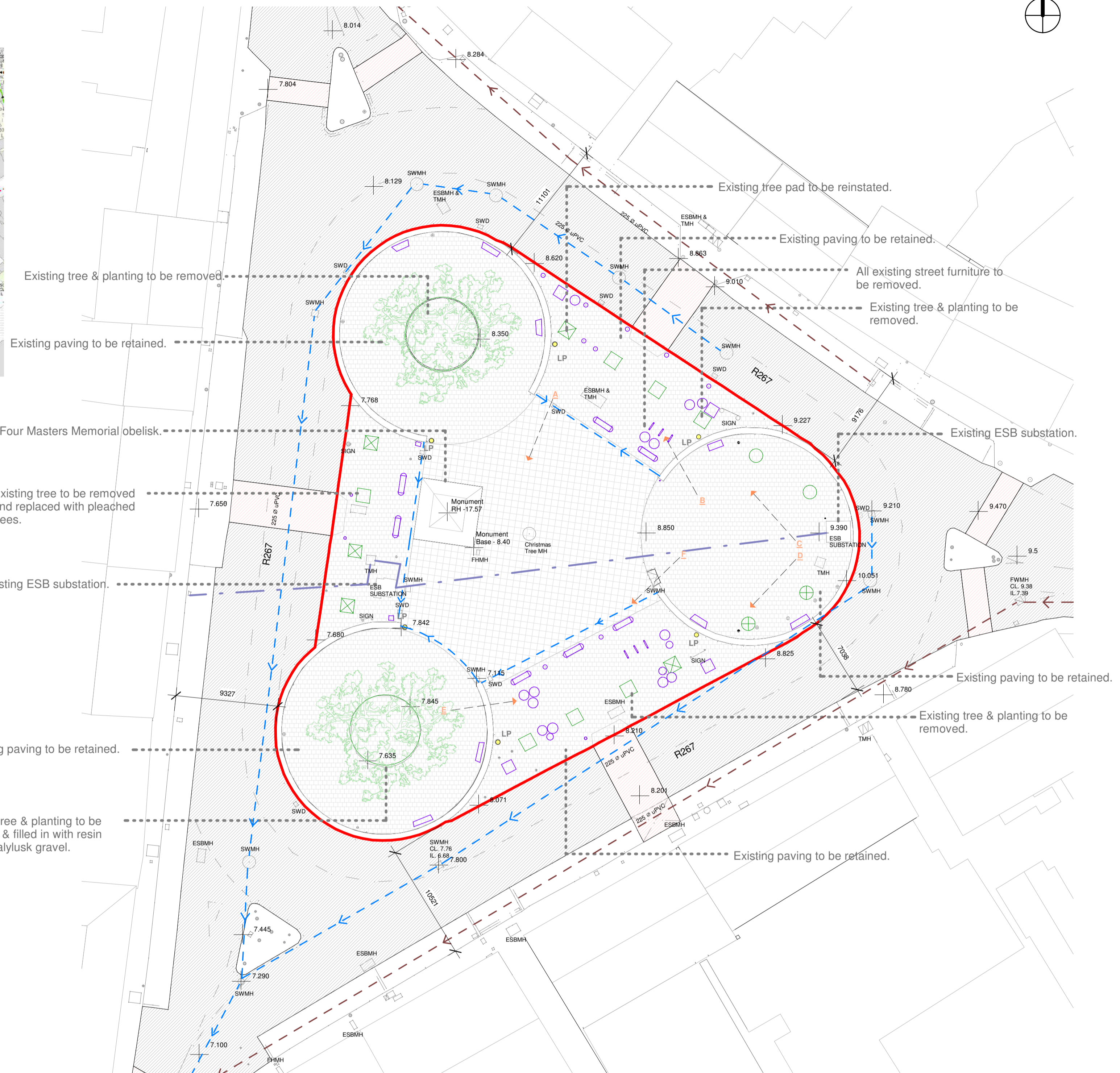

Existing Site Layout

1 : 250



Existing Site Image - 1



Existing Site Image - 2



Image - A

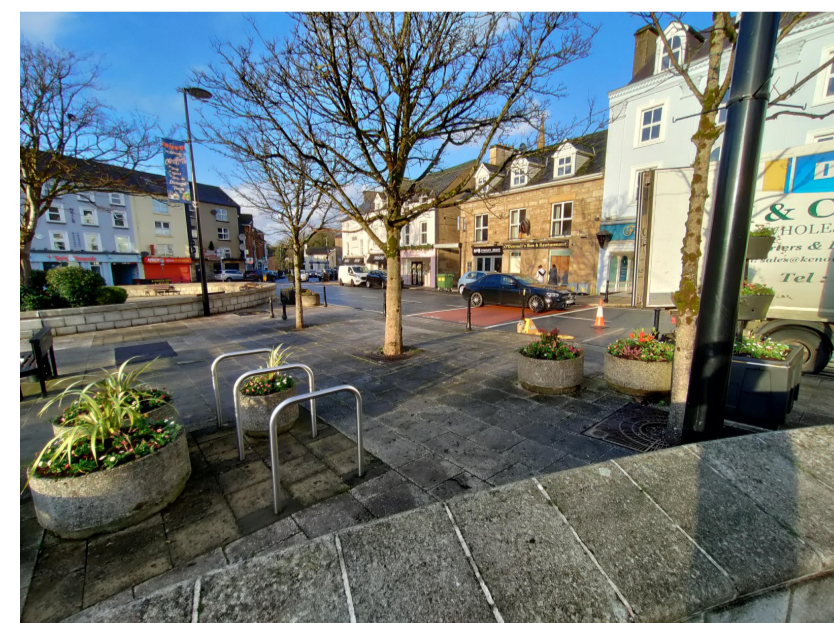

Image - B



Image - C



Image - D



Image - E



Image - F

Existing Site Legend	
	Existing Paving
	Existing Crossway
	Existing tree to be removed
	Location of previously removed trees
	Street Lighting - LP
	Street Furniture to be removed
	Foul Water
	Stormwater
	ESB underground cable
	Surface Water Drain - SWD
	Foul Water Manhole - FWMH
	Storm Water Manhole - SWMH
	Fire Hydrants Manhole - FHMH
	ESB
	Telecom - TMH



Comhairle Contae Dhún na nGall
Donegal County Council



PAUL DOHERTY ARCHITECTS LTD

CASTLE STREET | 5 ANVIL COURT
DONEGAL TOWN | KILLYBEGS
CO. DONEGAL | CO. DONEGAL

TEL: 074 97 23131
EMAIL: paul@dohertyarchitects.com



Status Key

SL	Survey
SK	Sketch Design
INFO	Information
PL	Planning Part - 8
DD	Detailed Design
FSC	Fire Safety Cert.
DAC	Dis. Acc. Cert.
T	Tender
C	Construction
CPO	CPO
SF	Safety File
O	Other

Rev:	Date:	Description:	Issued by:

Project Title:	OPPS WORKS TO THE DIAMOND DONEGAL TOWN, COUNTY DONEGAL
Location:	The Diamond, Donegal Town, Co.Donegal
Drawing Title:	Site Location Map & Existing Site Layout
Scale:	As indicated @A1
Drawn By:	John Kelly
Checked By:	Checker
Approved By:	Approver

First Issue Date:	Apr 2022	Status:	PL
Drawing No.:	PL.001	Revision:	
Project No.:	22-21		