

A project supported by the European  
Union's PEACE IV Programme, managed by  
the Special EU Programme Body (SEUPB)



**Rialtas  
na hÉireann**  
Government  
of Ireland

**Tionscadal Éireann**  
Project Ireland  
**2040**



**CHOMHARLE CONTAE DHÚN NA NGALL  
DONEGAL COUNTY COUNCIL**

**PLANNING AND DEVELOPMENT ACT 2000 (as amended) PLANNING AND DEVELOPMENT  
REGULATIONS 2001 (as amended)  
ARTICLE 81**

**Rossnowlagh Playground**

**Part 8 Planning Report**

Prepared by : Donegal County Council  
Community Development  
Station Island  
Lifford  
Co Donegal

Date : January 2020

# Document Control Sheet

Client Details	Municipal District - Donegal
	Work on behalf of the Donegal Municipal District

Report Title	Part 8 Planning Report
Project Name	Rossnowlagh Playground
Location	Rossnowlagh, Co. Donegal
Project Ref:	C&E Projects\2019014

Rev.No	Status	Report Date	Author(s)		Reviewed By		Approved By	
A	Final	January 2020	JD	01/20	SM	01/20	JK	01/20

## **1. Introduction**

Donegal County Council proposes to carry out development of a playground, sheltered seating area, outdoor showers and an area for traders in Rossnowlagh in the townland of Rossnowlagh Lower in the Donegal Municipal District.

## **2. Extents & Nature of the Works**

The proposed development is contained within a 0.51ha site, adjacent to L-2285-1, located in the village of Rossnowlagh and will include the following works;

1. Development of a public playground area incorporating a secure soft play area with seats.
2. Sheltered seating area with picnic tables.
3. Outdoor showers.
4. A designated area for traders to park.
5. Associated ancillary works to include site clearance, site drainage connected to public storm / foul sewer systems, fencing with gates, connection to services, landscaping, appropriate boundary treatment and development related signage.

The overall extent of the works is shown on Drawing No. 2019014-01-001 Site Location & Extents.

# **Appendix A**

## **Planning Notice**

# Site Notice



A Project supported by the European Union's PEACE IV Programme, managed by the Special EU Programme Body (SEUPB)



**Comhairle Contae  
Dhún na nGall**  
Donegal County Council



**Rialtas  
na hÉireann**  
Government  
of Ireland

**Tionscadal Éireann  
Project Ireland  
2040**



**PLANNING AND DEVELOPMENT ACT 2000 (as amended)  
PLANNING AND DEVELOPMENT REGULATIONS 2001 (as amended)  
ARTICLE 81**

**NOTICE PURSUANT TO ARTICLE 81, PART 8 OF THE ABOVE REGULATIONS, RELATING TO A PROPOSED  
DEVELOPMENT BY DONEGAL COUNTY COUNCIL**

TAKE NOTICE that Donegal County Council proposes to carry out the following development of a playground and public realm works in the townland of Rossnowlagh Lower, located in the Donegal Municipal District as scheduled below.

**SCHEDULE OF PROPOSED WORK**

No.	Title	Townlands	Local Office(s) For Viewing Plans
1	Rossnowlagh Playground	Rossnowlagh Lower	Donegal County Council, County House, The Diamond, Lifford, F93 Y622
			Donegal Town Public Service Centre, Drumlonagher, Donegal Town, Co Donegal, F94 DK6C
Description and Extents			
Donegal County Council proposes to carry out the development of a playground, sheltered seating area, outdoor showers and an area for traders in Rossnowlagh in the townland of Rossnowlagh Lower in the Donegal Municipal District.			
The proposed development will include the following works;			
1. Development of a public playground area incorporating a secure soft play area with seats.			
2. Sheltered seating area with picnic tables.			
3. Outdoor showers.			
4. A designed area for traders to park.			
5. Associated ancillary works to include site clearance, site drainage connected to the public storm / foul sewer system, fencing with gates, connection to services, landscaping, appropriate boundary treatment and development related signage.			

Note that in accordance with Article 120(1)(b)(i) of the Planning and Development Regulations 2001 (as amended) Donegal County Council has concluded, based on a preliminary examination of the nature, size and location of the development, that the Environmental Impact Assessment Report (EIAR) is not required.

The plans and particulars of this proposed development will be available for inspection (or purchase at a fee not exceeding the reasonable cost of making a copy,) at

Location	Address	Opening Hours
Reception, Donegal County Council	County House, Lifford, Co. Donegal, F93 Y622	9:00am – 12.30pm and 1.00pm – 5.00pm from Monday to Thursday and from 9:00am – 12.30pm and 1.00pm – 4.30p.m on Fridays.
Donegal Town Public Service Centre	Drumlonagher, Donegal Town, Co Donegal, F94 DK6C	9:00am – 12.30pm and 1.00pm – 5.00pm from Monday to Thursday and from 9:00am – 12.30pm and 1.00pm – 4.30p.m on Fridays.

The proposed plans will be available for inspection from Friday 24<sup>th</sup> January 2020 – Friday 21<sup>st</sup> February 2020.

Submissions and observations with respect to the proposed development, dealing with the proper planning and development of the area in which the development is situated may be made in writing to The Co. Secretariat, Donegal County Council, Lifford, County Donegal, before 4.30pm on Friday 6<sup>th</sup> March 2020.

**Please mark the front of the envelope with the project name as per the above schedule.**

**Signed: Liam Ward, Director of Service  
Community Development & Planning Services, Donegal County Council, County House, Lifford.**

*Advertised in the Donegal Post on Wednesday 22<sup>nd</sup> January 2020*

A digital copy of the documents will be available for viewing / download via Donegal County Council's website at the following address: [www.donegalcoco.ie/community/publicconsultations/](http://www.donegalcoco.ie/community/publicconsultations/)

# **Appendix B**

## **Environmental Impact Assessment Preliminary Examination**

**STAGE 1.a – EIA PRE-SCREENING**

<b>Case Ref:</b>	2019014 – Rossnowlagh Playground		
<b>Development Summary</b>	Development of a public playground and public realm works, incorporating a secure soft play area with seats and benches, a sheltered seating area with picnic tables, outdoor showers, a designed area for traders to park and associated ancillary works to include site clearance, site drainage connected to public storm / foul sewer systems, fencing with gates, connection to services, landscaping, appropriate boundary treatment and development related signage.		
<b>Does the proposed development constitute an EIA project?</b> (that is involving construction works or interventions in the natural surroundings)		Yes	X
		No	
<b>If YES, Does the proposed development fall within a class of development set out in Part 1 or Part 2, Schedule 5 of the Planning and Development Regulations, 2001 (as amended)?</b>			
<b>Tick</b>	<b>Threshold</b>	<b>Comment</b>	<b>Result</b>
Yes			
*No	X	Works are not within the Donegal Bay Special Protection Area and all development related drainage will be connected to the existing public sewer system.	

\* If 'No' is ticked in the box above, there is no requirement to complete Stage 1.b – EIA Screening – Preliminary Examination (next page)

<b>CONCLUSION</b>	
Development is not within Part 1 or Part 2, Schedule 5. <b>No EIA/Screening is required.</b>	X (No EIA/Screening is required)
Development is within Part 1 or Part 2 and is greater than, equal to, or there is no threshold. <b>EIAR is required.</b>	
Development is within Part 1 or Part 2 but is less than threshold. <b>EIA Screening is Required.</b>	

**Stage 1.b – EIA Screening - Preliminary Examination**

<b>Case Ref:</b>			
<b>Development Summary:</b>			
<b>EXAMINATION</b>			
	<b>Yes /No/ Uncertain</b>	<b>Comment:</b>	
Is the size of the development exceptional in the context of the existing environment?	No		
Is the proposed development located on, in, adjoining or have the potential to impact on a sensitive site or location?	No		
Will the development result in the production of any significant waste, or result in emissions or pollutants?	No		
<b>CONCLUSION</b>			
<b>Based on a preliminary examination of the nature, size or location of the development is there a real likelihood of significant effects on the environment?</b>			
There is no real likelihood of significant effects on the environment	<b>EIAR not required</b>		
There is significant and realistic doubt in regard to the likelihood of significant effects on the environment	<b>Stage 2 Screening Determination Required</b>		
	<b>Schedule 7A information required from Applicant?</b>	<b>Yes</b>	<b>No</b>
There is a real likelihood of significant effects on the environment	<b>EIAR Required</b>		

Case Officer:

Date:



# **Appendix C**

## **TTS 1 Traffic and Transport Statement**



<b>TTS 1</b>	<b>TRAFFIC AND TRANSPORT STATEMENT</b>
QUESTIONS 1-3 TO BE COMPLETED FOR ALL PLANNING APPLICATIONS	

Local Authority	Donegal County Council	Reference number	
		(Office use only)	
<b>1</b>	<b>Application Details:</b>		
Name	Rossnowlagh Playground		
Development Address	Rossnowlagh, Co Donegal		
		Eircode	N/A

<b>2</b>	<b>Development Details</b>		
Description of proposed Development	Public playground area incorporating a secure soft play area with seats, a sheltered seating area with picnic tables, outdoor showers, a designated area for traders to park and associated ancillary works.		
On which road(s) does site have frontage(s) Provide Road number(s)		<del>N-/ R-/ L</del> (L-2285-1) The site does not have direct frontage onto the local road	

<b>3</b>	<b>Single Dwelling House</b>		
Is the proposed development only a single dwelling house?			Yes/No

If the answer to 3 above is "Yes" go to section 5, if the answer to 3 above is "No" complete section 4

<b>Section 4</b>	<b>Traffic and Transport Impacts</b>				
What is the size of the proposed development? (m <sup>2</sup> or no of units)				0.51 ha site	
How many trips will be made per day to the site?					
Car driver	20	Pedestrian	15	Bus / Tram	N/A
Car passenger	35	Cyclist	12	Rail	N/A
HCV (Indicate type/size)	N/A	Taxi	1	Total	83
Will traffic to/from the development be more than 10% of existing traffic on the adjoining road (5% in case of an already congested road)?					Yes/No
Is a new or modified access to the site needed to join the existing road network?					Yes/No
What changes to the existing road layout are required as a result of this development?		None			
Is there existing public transport access to the development? Describe.		Rossnowlagh village is served by the local link route 982 Sligo – Rossnowlagh (Wild Atlantic Way)			
What specific public transport provision is to be made as part of the development?		TBC by Donegal County Council			
What specific provision is to be made for pedestrians/cyclists as part of the development?		The proposed development adjoins the existing public footpath with provision of public seating areas and room to park bikes			

## Section 5

I believe the statements outlined above to be a fair and competent assessment of the effects of the development described above on the adjoining road network and access routes. I further believe the changes proposed in this assessment will effectively remedy the possible adverse effects on road capacity and safety caused by this development

Donegal County Council

08/01/2020

Signed..... Developer

Date.....

Signed..... Agent

Date.....

# Appendix D

## Drawings

Drawing No.	Title
2019014-01-001	Site Location & Extents
2019014-01-002	Site Layout
2019014-01-003	Playground Layout & Sections



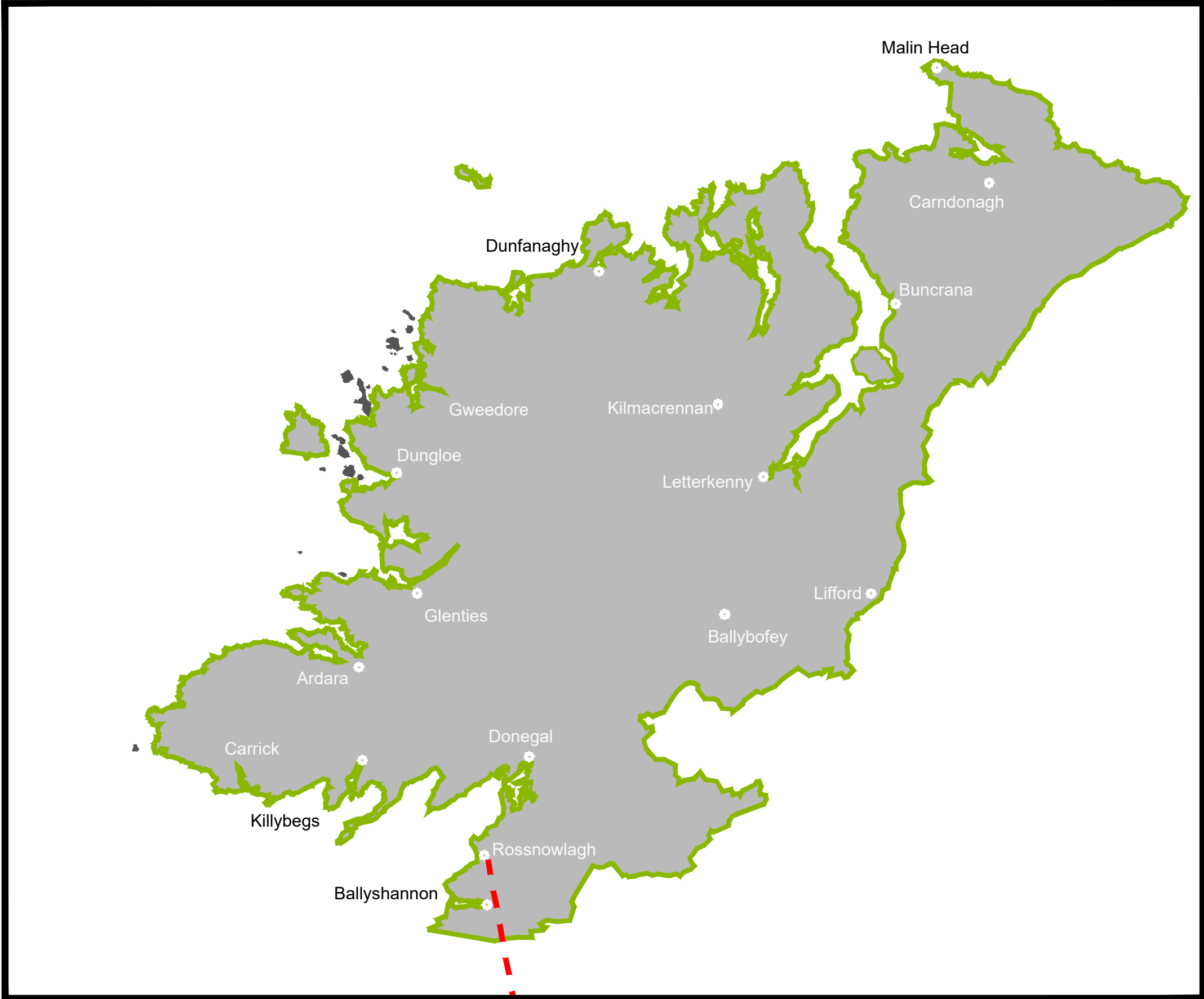

Site Location Map (Not to Scale)



Site Location (Not to Scale)

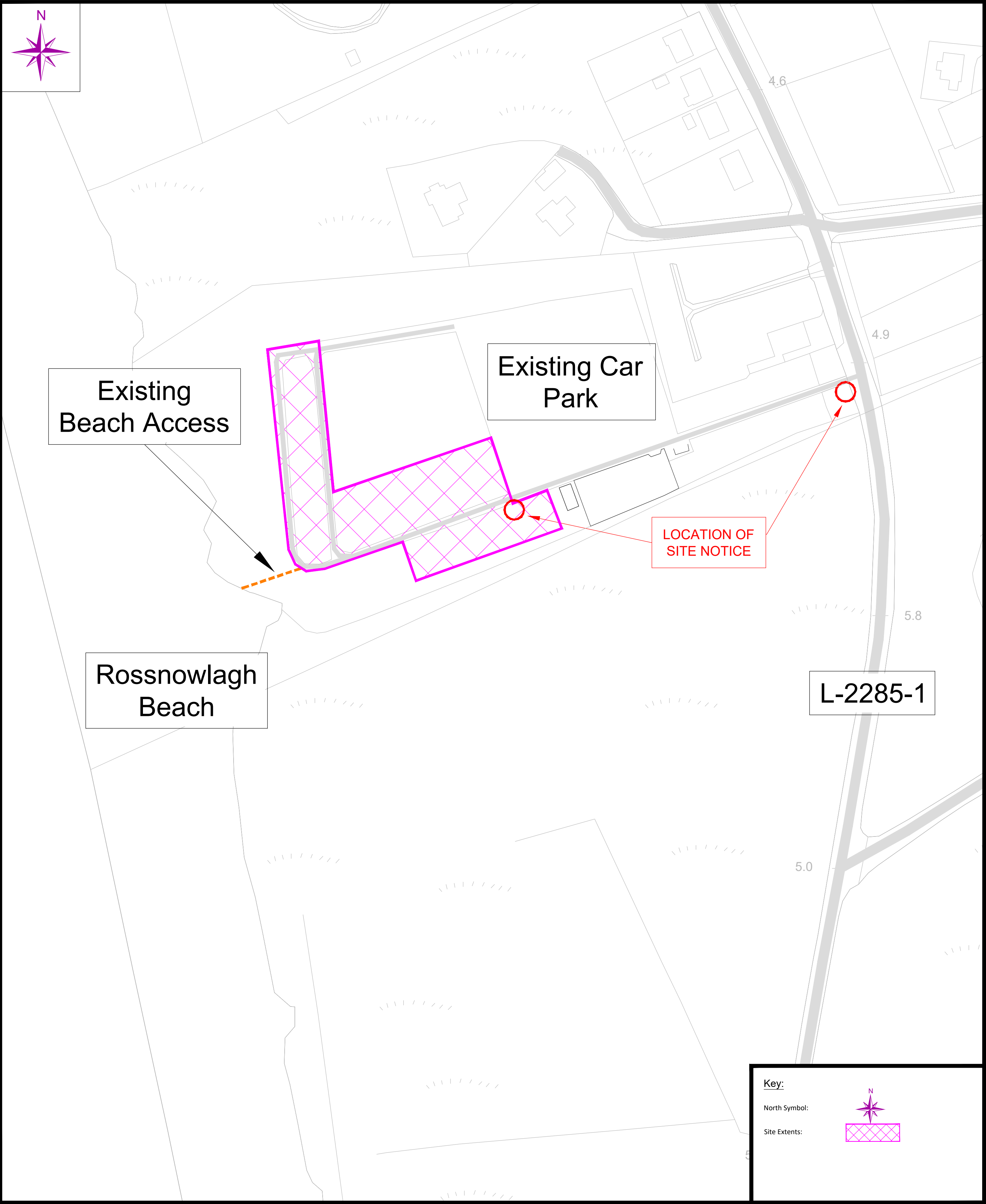

Site Extents Layout (Scale: 1:1000 @ A1)



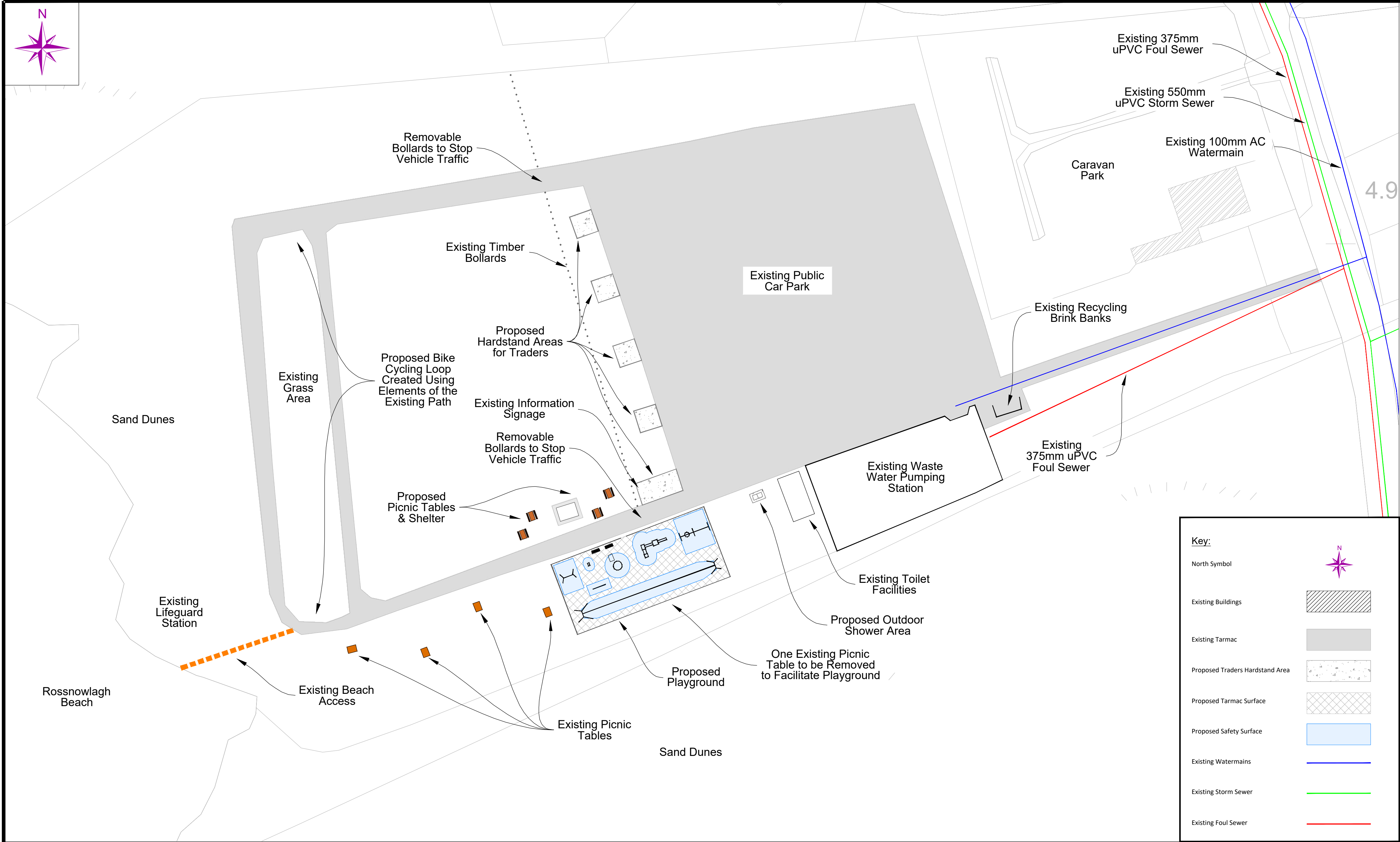

Site Layout (Scale: 1:500@ A1)

Example of Communal Spaces & Shelters



Typical Sections of Communal Shelter

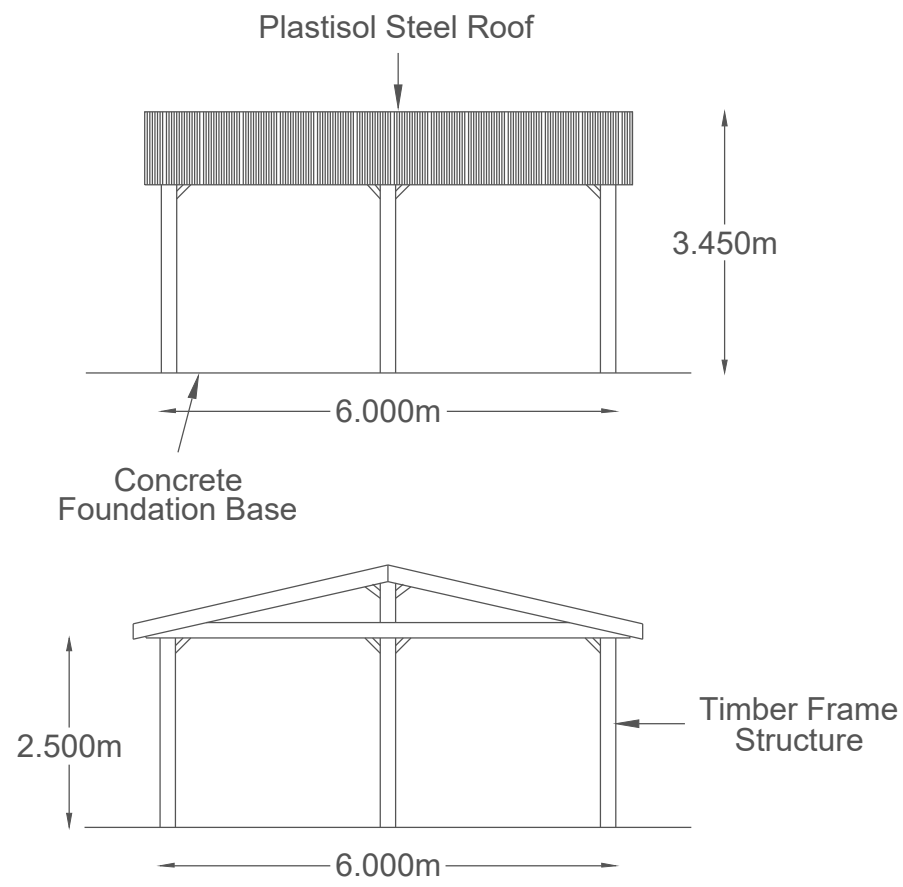

Typical Elevation of Outdoor Shower

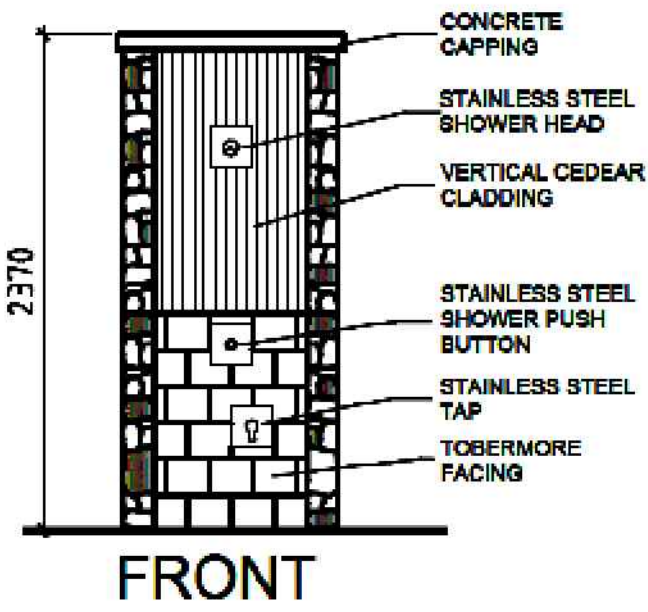

Examples of Boundary Fence



Examples of Play Equipment



Rev	By	Date	Description
A	JD	01/2020	

Purpose of Dwg:

☐ Information

☒ Part 8

☐ Tender

☐ Construction

☐ Safety File

☐ Other

Prepared:	JD	Date:	Jan 2020
Checked:	SM	Date:	Jan 2020
Approved:	JK	Date:	Jan 2020

Horizontal Scale:	As Shown
Vertical Scale:	As Shown
File no.:	Q:\Bridges & EIS\IC&E Projects\2019014 Rossnowlagh Playground\002 Part 8

Project:	Rossnowlagh Playground
Location:	Rossnowlagh, Co Donegal
Dwg Title:	Site Layout

Rev:	A
Drawing no:	2019014-01-002



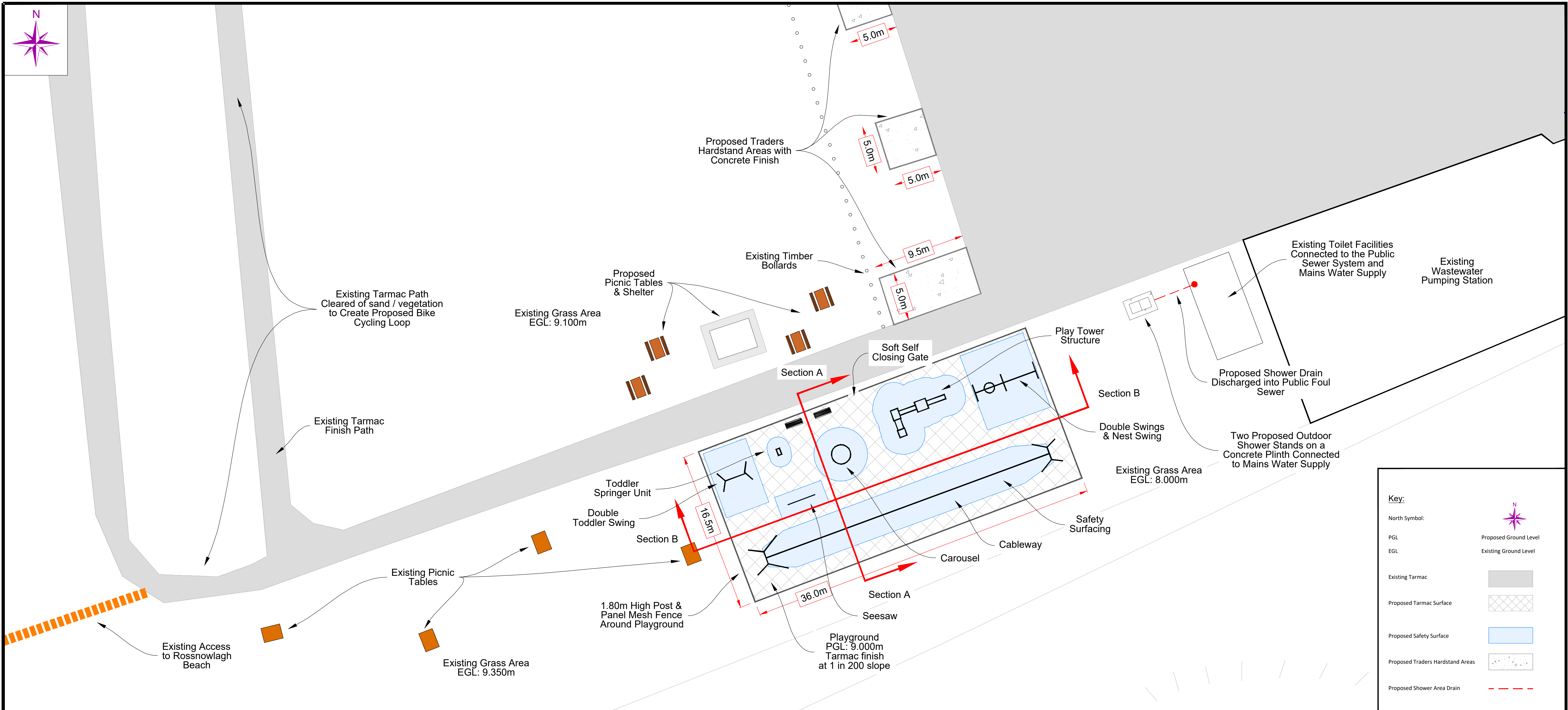

Playground Layout (Scale: 1:200@ A1)

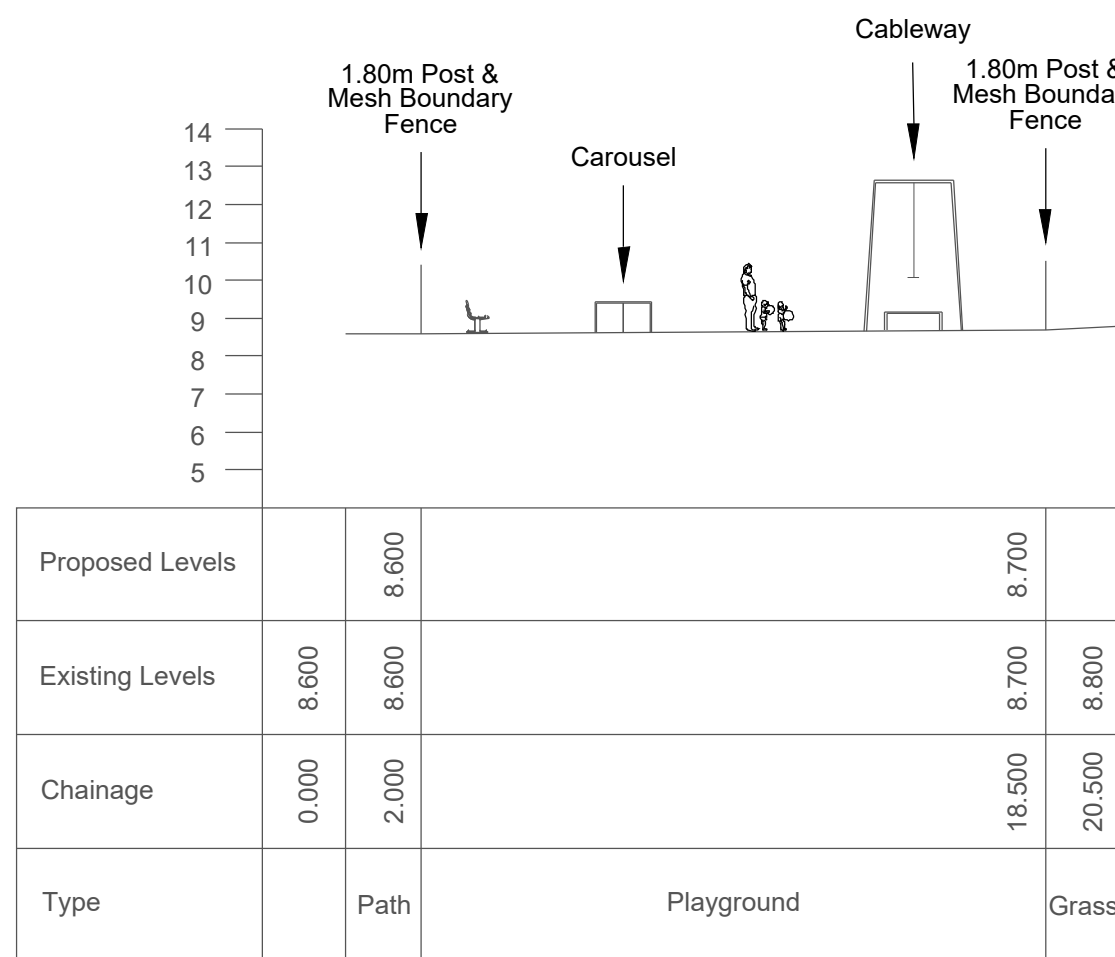

Section A-A  
Scale 1:200

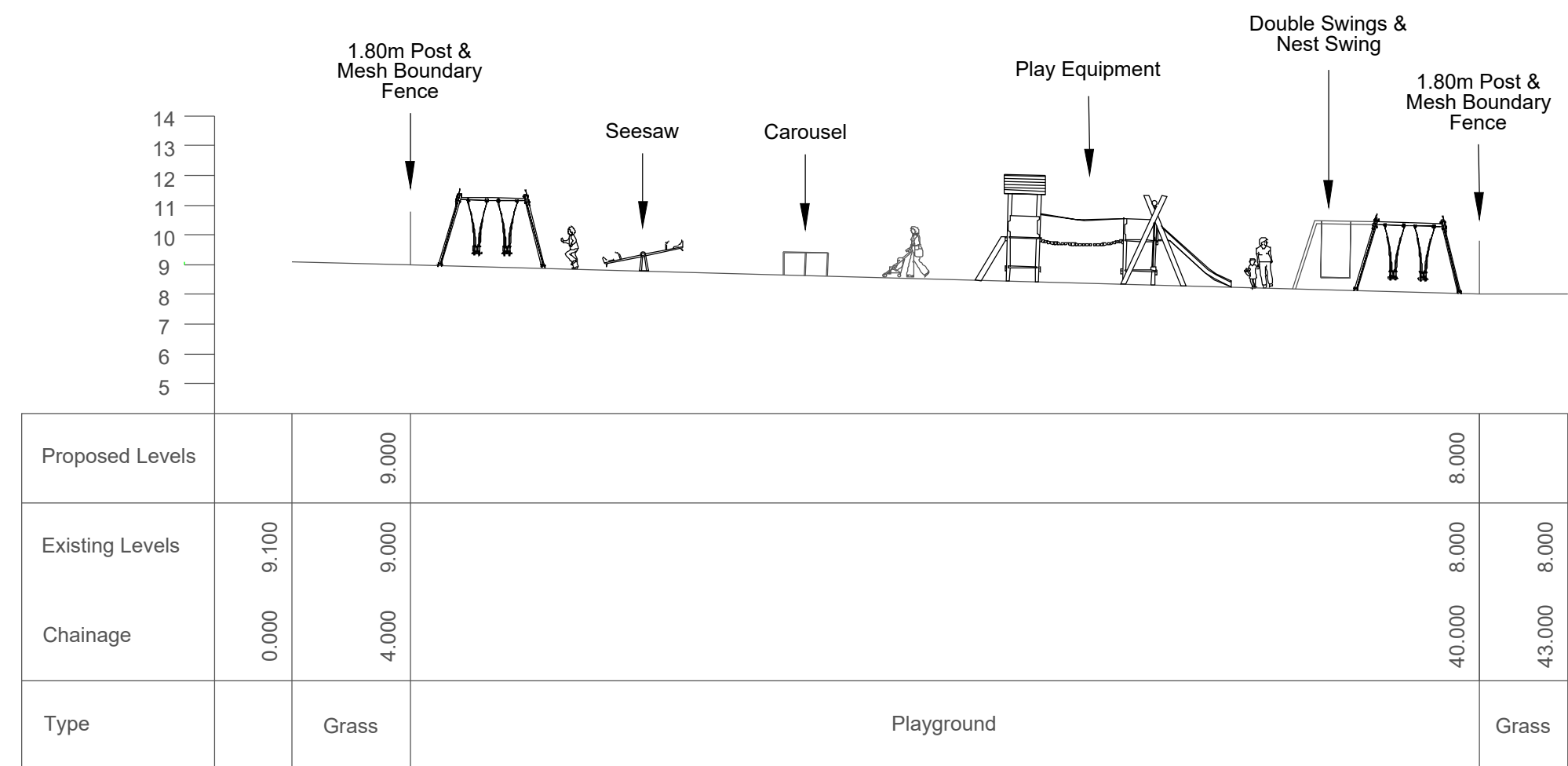

Section B-B  
Scale 1:200